



JOIN

FOR THOSE WHO DARE

ROG

STRIX XG27ACSR SERIES

GAMING MONITOR



ASUS

Table of contents

| | |
|---|------|
| Notices | iii |
| Safety information | v |
| Care & Cleaning | ix |
| Takeback Services | x |
| 1.1 Welcome | 1-1 |
| 1.2 Package contents..... | 1-1 |
| 1.3 Assembling the monitor | 1-2 |
| 1.4 Detaching the arm/stand (for VESA wall mount) | 1-3 |
| 1.5 Cable management(include I/O port) | 1-4 |
| 1.6 Adjusting the monitor | 1-5 |
| 2.1 Monitor introduction | 2-1 |
| 2.1.1 Front view | 2-1 |
| 2.1.2 Back view | 2-4 |
| 2.1.3 Other Function(s) | 2-5 |
| 3.1 OSD (On-Screen Display) menu | 3-1 |
| 3.1.1 How to reconfigure | 3-1 |
| 3.1.2 OSD Function Introduction..... | 3-3 |
| 3.2 Display Widget Center | 3-16 |
| 3.3 Specifications summary..... | 3-18 |
| 3.4 Outline dimension..... | 3-20 |
| 3.5 Troubleshooting (FAQ)..... | 3-21 |
| 3.6 Supported Timing List..... | 3-22 |

Copyright © 2026 ASUSTeK COMPUTER INC. All Rights Reserved.

No part of this manual, including the products and software described in it, may be reproduced, transmitted, transcribed, stored in a retrieval system, or translated into any language in any form or by any means, except documentation kept by the purchaser for backup purposes, without the express written permission of ASUSTeK COMPUTER INC. ("ASUS").

Product warranty or service will not be extended if: (1) the product is repaired, modified or altered, unless such repair, modification of alteration is authorized in writing by ASUS; or (2) the serial number of the product is defaced or missing.

ASUS PROVIDES THIS MANUAL "AS IS" WITHOUT WARRANTY OF ANY KIND, EITHER EXPRESS OR IMPLIED, INCLUDING BUT NOT LIMITED TO THE IMPLIED WARRANTIES OR CONDITIONS OF MERCHANTABILITY OR FITNESS FOR A PARTICULAR PURPOSE. IN NO EVENT SHALL ASUS, ITS DIRECTORS, OFFICERS, EMPLOYEES OR AGENTS BE LIABLE FOR ANY INDIRECT, SPECIAL, INCIDENTAL, OR CONSEQUENTIAL DAMAGES (INCLUDING DAMAGES FOR LOSS OF PROFITS, LOSS OF BUSINESS, LOSS OF USE OR DATA, INTERRUPTION OF BUSINESS AND THE LIKE), EVEN IF ASUS HAS BEEN ADVISED OF THE POSSIBILITY OF SUCH DAMAGES ARISING FROM ANY DEFECT OR ERROR IN THIS MANUAL OR PRODUCT.

SPECIFICATIONS AND INFORMATION CONTAINED IN THIS MANUAL ARE FURNISHED FOR INFORMATIONAL USE ONLY, AND ARE SUBJECT TO CHANGE AT ANY TIME WITHOUT NOTICE, AND SHOULD NOT BE CONSTRUED AS A COMMITMENT BY ASUS. ASUS ASSUMES NO RESPONSIBILITY OR LIABILITY FOR ANY ERRORS OR INACCURACIES THAT MAY APPEAR IN THIS MANUAL, INCLUDING THE PRODUCTS AND SOFTWARE DESCRIBED IN IT.

Products and corporate names appearing in this manual may or may not be registered trademarks or copyrights of their respective companies, and are used only for identification or explanation and to the owners' benefit, without intent to infringe.

Notices

Federal Communications Commission Statement

This device complies with Part 15 of the FCC Rules. Operation is subject to the following two conditions:

- This device may not cause harmful interference.
- This device must accept any interference received including interference that may cause undesired operation.

This equipment has been tested and found to comply with the limits for a Class B digital device, pursuant to Part 15 of the FCC Rules. These limits are designed to provide reasonable protection against harmful interference in a residential installation. This equipment generates, uses and can radiate radio frequency energy and, if not installed and used in accordance with the instructions, may cause harmful interference to radio communications. However, there is no guarantee that interference will not occur in a particular installation. If this equipment does cause harmful interference to radio or television reception, which can be determined by turning the equipment off and on, the user is encouraged to try to correct the interference by one or more of the following measures:

- Reorient or relocate the receiving antenna.
- Increase the separation between the equipment and receiver.
- Connect the equipment to an outlet on a circuit different from that to which the receiver is connected.
- Consult the dealer or an experienced radio/TV technician for help.



The use of shielded cables for connection of the monitor to the graphics card is required to assure compliance with FCC regulations. Changes or modifications to this unit not expressly approved by the party responsible for compliance could void the user's authority to operate this equipment.

Canadian Department of Communications Statement

This digital apparatus does not exceed the Class B limits for radio noise emissions from digital apparatus set out in the Radio Interference Regulations of the Canadian Department of Communications.

This class B digital apparatus complies with Canadian ICES-003.

This Class B digital apparatus meets all requirements of the Canadian Interference-Causing Equipment Regulations.

Cet appareil numérique de la classe B respecte toutes les exigences du Règlement sur le matériel brouiller du Canada.

Declaration of Conformity

This device complies with the requirements set out in the Council Directive on the Approximation of the Laws of the Member States relating to Electromagnetic Compatibility (2014/30/EU), Low-voltage Directive (2014/35/EU), REGULATION (EU) 2024/1781 and RoHS directive (2011/65/EU). This product has been tested and found to comply with the harmonized standards for Information Technology Equipment, these harmonized standards published under Directives of Official Journal of the European Union.

WEEE Symbol Statement

This symbol on the product or on its packaging indicates that this product must not be disposed of with your other household waste. Instead, it is your responsibility to dispose of your waste equipment by handing it over to a designated collection point for the recycling of waste electrical and electronic equipment. The separate collection and recycling of your waste equipment at the time of disposal will help to conserve natural resources and ensure that it is recycled in a manner that protects human health and the environment. For more information about where you can drop off your waste equipment for recycling, please contact your local city office, your household waste disposal service or the shop where you purchased the product.



Safety information

- Before setting up the monitor, carefully read all the documentation that came with the package.
- To prevent fire or shock hazard, never expose the monitor to rain or moisture.
- Never try to open the monitor cabinet. The dangerous high voltages inside the monitor may result in serious physical injury.
- If the power supply is broken, do not try to fix it by yourself. Contact a qualified service technician or your retailer.
- Before using the product, make sure all cables are correctly connected and the power cables are not damaged. If you detect any damage, contact your dealer immediately.
- Slots and openings on the back or top of the cabinet are provided for ventilation. Do not block these slots. Never place this product near or over a radiator or heat source unless proper ventilation is provided.
- The monitor should be operated only from the type of power source indicated on the label. If you are not sure of the type of power supply to your home, consult your dealer or local power company.
- Use the appropriate power plug which complies with your local power standard.
- Do not overload power strips and extension cords. Overloading can result in fire or electric shock.
- Avoid dust, humidity, and temperature extremes. Do not place the monitor in any area where it may become wet. Place the monitor on a stable surface.
- Unplug the unit during a lightning storm or if it will not be used for a long period of time. This will protect the monitor from damage due to power surges.
- Never push objects or spill liquid of any kind into the slots on the monitor cabinet.
- To ensure satisfactory operation, use the monitor only with UL listed computers which have appropriate configured receptacles marked between 100 ~ 240V AC.
- The socket-outlet shall be installed near the equipment and shall be easily accessible
- If you encounter technical problems with the monitor, contact a qualified servicer.
- Provide an earthing connection before the mains plug is connected to the mains. And, when disconnecting the earthing connection, be sure to disconnect after pulling out the mains plug from the mains.

- Please confirm the distribution system in building installation shall provide the circuit breaker rated 120/240V, 20A (maximum).
- If provided with a 3-pin attachment plug on the power cord, plug the cord into a grounded (earthed) 3-pin outlet. Do not disable the power cord grounding pin, for example, by attaching a 2-pin adapter. The grounding pin is an important safety feature.

Stability Hazard

- The product may fall, causing serious personal injury or death. To prevent injury, this product must be securely attached to the floor/wall in accordance with the installation instructions.
- A product may fall, causing serious personal injury or death. Many injuries, particularly to children, can be avoided by taking simple precautions such as:
 - ALWAYS use cabinets or stands or installation methods recommended by the manufacturer of the product set.
 - ALWAYS use furniture that can safely support the product.
 - ALWAYS ensure the product is not overhanging the edge of the supporting furniture.
 - ALWAYS educate children about the dangers of climbing on furniture to reach the product or its controls.
 - ALWAYS route cords and cables connected to your product so they cannot be tripped over, pulled or grabbed.
 - NEVER place a product in an unstable location.
 - NEVER place the product on tall furniture (for example, cupboards or bookcases) without anchoring both the furniture and the product to a suitable support.
 - NEVER place the product on cloth or other materials that may be located between the product and supporting furniture.
 - NEVER place items that might tempt children to climb, such as toys and remote controls, on the top of the product or furniture on which the product is placed.
- If the existing product is going to be retained and relocated, the same considerations as above should be applied.

ASUS CONTACT INFORMATION

| | | |
|---|--|--|
| ▪ ASUSTeK Computer Inc. Address 1F., No. 15, Lide Rd., Beitou Dist., Taipei City 112, Taiwan Telephone +886-2-2894-3447 Fax +886-2-2894-7798 E-mail info@asus.com.tw Website http://www.asus.com.tw/ | ▪ ASUS Computer International (America) Address 48720 Kato Rd, Fremont, CA 94538, USA Telephone +1-510-739-3777 Fax +1-510-608-4555 Website http://usa.asus.com/ | ▪ ASUS Computer GmbH (Germany and Austria) Address Harkortstr. 21-23 D-40880 Ratingen, Germany Telephone +49-1805-010920 Website http://www.asus.de/ Online Contact http://www.asus.de/sales |
| ▪ Technical Support Telephone +86-21-38429911 | ▪ Technical Support Telephone +1-812-282-2787 (English Only) +1-905-370-2787 (French Only) Online Support http://support.asus.com/ | ▪ Technical Support Telephone +49-1805-010923 Support Fax +49-2102-959911 Online Support http://support.asus.com/ |

WARNING

Usage of other than specified head- or earphones can result in hearing loss due to excessive sound pressures.

Excessive sound pressure from earphones and headphones can cause hearing loss. Adjustment of the equalizer to maximum increases the earphones and headphones output voltage and therefore the sound pressure level.

Do not dispose of electrical appliances as unsorted municipal waste, use separate collection facilities.

Contact your local government for information regarding the collection systems available.

If electrical appliances are disposed of in landfills or dumps, hazardous substances can leak into the groundwater and get into the food chain, damaging your health and well-being.

When replacing old appliances with new ones, the retailer is legally obligated to take back your old appliance for disposal at least for free of charge.

Restriction on Hazardous Substances statement (India)

This product complies with the "India E-Waste (Management) Rules, 2016" and prohibits use of Lead, Mercury, Hexavalent Chromium, polybrominated biphenyls (PBBs) and polybrominated diphenyl ethers (PBDEs) in concentration exceeding 0.1% by weight in homogenous materials and 0.01% by weight in homogenous materials for cadmium, except of exemptions listed in Schedule 2 of the Rule.

HDMITM
HIGH-DEFINITION MULTIMEDIA INTERFACE

EAC

Prevent Tipping

When using the display, fasten the LCD to a wall using a cord or chain that can support the weight of the monitor in order to prevent the monitor from falling.

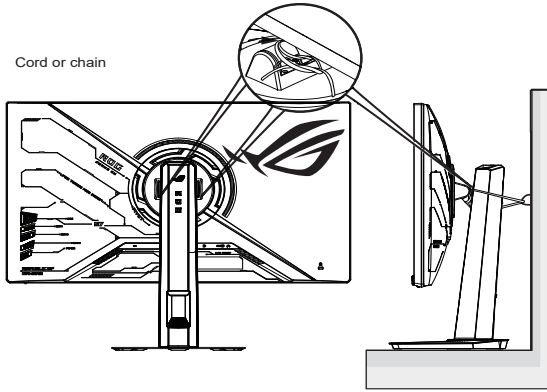

- Display design may differ from those illustrated.
- Installing must be done by a qualified technician , and please contact your supplier for more information.
- For the Models with net weight $\geq 7\text{kg}$. Please select the suitable way to Prevent Tipping.
- For the models with VESA Mount, please use method ❶, install the screws with ring to the VESA Mount hole, then tie the cord or chain to the wall. Otherwise, please use method ❷ to tie the cord or chain to the stand and then fix it to the wall.

Care & Cleaning

- Before you lift or reposition your monitor, it is better to disconnect the cables and power cord. Follow the correct lifting techniques when positioning the monitor. When lifting or carrying the monitor, grasp the edges of the monitor. Do not lift the display by the stand or the cord.
- Cleaning. Turn your monitor off and unplug the power cord. Clean the monitor surface with a lint-free, non-abrasive cloth. Stubborn stains may be removed with a cloth dampened with mild cleaner.
- Avoid using a cleaner containing alcohol or acetone. Use a cleaner intended for use with the LCD. Never spray cleaner directly on the screen, as it may drip inside the monitor and cause an electric shock.



This symbol of the crossed out wheeled bin indicates that the product (electrical, electronic equipment, and mercury-containing button cell battery) should not be placed in municipal waste. Please check local regulations for disposal of electronic products.

AEEE yönetmeliğine uygundur

The following symptoms are normal with the monitor:

- The screen may flicker during the initial use due to the nature of the fluorescent light. Turn off the Power Switch and turn it on again to make sure that the flicker disappears.
- You may find slightly uneven brightness on the screen depending on the desktop pattern you use.
- When the same image is displayed for hours, an afterimage of the previous screen may remain after switching the image. The screen will recover slowly or you can turn off the Power Switch for hours.
- When the screen becomes black or flashes, or cannot work anymore, contact your dealer or service center to fix it. Do not repair the screen by yourself!

Conventions used in this guide



WARNING: Information to prevent injury to yourself when trying to complete a task.



CAUTION: Information to prevent damage to the components when trying to complete a task.



IMPORTANT: Information that you **MUST** follow to complete a task.



NOTE: Tips and additional information to aid in completing a task.

Where to find more information

Refer to the following sources for additional information and for product and software updates.

1. **ASUS websites**

The ASUS websites worldwide provide updated information on ASUS hardware and software products. Refer to <http://www.asus.com>

2. **Optional documentation**

Your product package may include optional documentation that may have been added by your dealer. These documents are not part of the standard package.

3. **Protect your eyes with ASUS EYE CARE Monitors**

The latest ASUS monitors feature exclusive Blue Light Filter and Flicker free technologies to keep your eyes healthy in today's digital world. Refer to

https://www.asus.com/Microsite/display/eye_care_technology/

4. **About Flicker:**

https://www.asus.com/Microsite/display/eye_care_technology/

5. **About Low Blue Light:**

<https://www.asus.com/us/support/FAQ/1009742/>

Takeback Services

ASUS recycling and takeback programs come from our commitment to the highest standards for protecting our environment. We believe in providing solutions for our customers to be able to responsibly recycle our products, batteries and other components as well as the packaging materials.

Please go to <http://csr.asus.com/english/Takeback.htm> for detail recycling information in different region.

Product information for EU energy label

XG27ACSR

XG27ACSR-W



1.1 Welcome

Thank you for purchasing the ASUS® LCD monitor!

The latest widescreen LCD monitor from ASUS provides a crisper, broader, and brighter display, plus a host of features that enhance your viewing experience.

With these features, you can enjoy the convenience and delightful visual experience that the monitor brings you!

1.2 Package contents

Check your package for the following items:

- ✓ LCD Monitor
- ✓ Monitor Stand
- ✓ Monitor Base
- ✓ Quick Start Guide
- ✓ Warranty Card
- ✓ Power Cord
- ✓ DP Cable
- ✓ ROG Sticker
- ✓ ROG Pouch



-
- If any of the above items is damaged or missing, contact your retailer immediately.
-

1.3 Assembling the monitor

To assemble the monitor:



- While assembling the monitor arm/base, we recommend that you keep the monitor inside its EPS (Expanded Polystyrene) packaging.
-

1. Place the display on a cloth on the table, gently attach the stand to the VESA mount area until the latch locks the stand, then attach the base to the arm and fix with the screw to join them tightly. You can easily tighten the screw by fingers.
2. Adjust the monitor to the angle that is most comfortable for you.

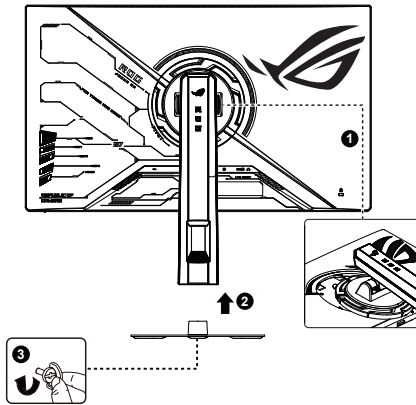

*Base screw size: M6 x 15 mm

1.4 Detaching the arm/stand (for VESA wall mount)



- We recommend that you cover the table surface with soft cloth to prevent damage to the monitor.

The detachable stand of this monitor is specially designed for VESA wall mount.

To detach the arm/stand

1. Disconnect power and signal cables. Carefully put the front of the monitor face down on a clean table.
2. Push the locking clips inward to detach the stand from the monitor.
3. Hold the stand with both hands, tilt the base and slide it out.
4. Detach the stand (arm and base) from the monitor.

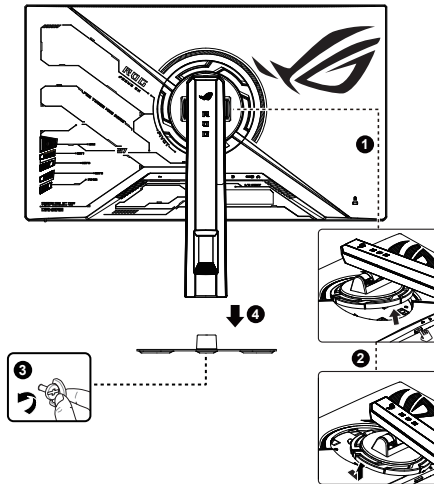

- The VESA wall mount kit (100 x 100 mm) is purchased separately.
- Use only the UL Listed Wall Mount Bracket with minimum weight/load 12 kg (Screw size: M4 x 10 mm).

1.5 Cable management(include I/O port)

You can organize the cables with the help of the cable management hole.

- **Arranging the cables**

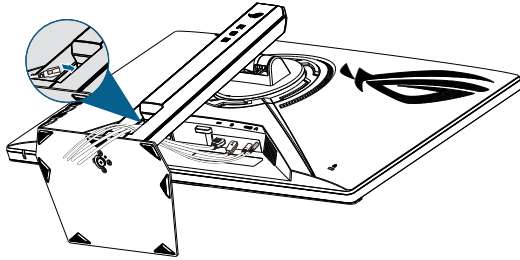

- **To connect the HDMI/DisplayPort/USB Type-C cable:**
 - a. Plug one end of the HDMI/DisplayPort/USB Type-C cable to the monitor's HDMI/DisplayPort/USB Type-C jack.
 - b. Connect the other end of the HDMI/DisplayPort/USB Type-C cable to your device's HDMI/DisplayPort/USB Type-C jack.



When these cables are connected, you can choose the desired signal from the Input Select item in the OSD menu.



If you need to replace the power cord or the connection cable(s), please contact ASUS customer service.

1.6 Adjusting the monitor

- For optimal viewing, we recommend that you look at the full face of the monitor, then adjust the monitor to the angle that is most comfortable for you.
- Hold the stand to prevent the monitor from falling when you change its angle.
- Adjust the monitor follow the pictures for the most comfortable viewing for you.

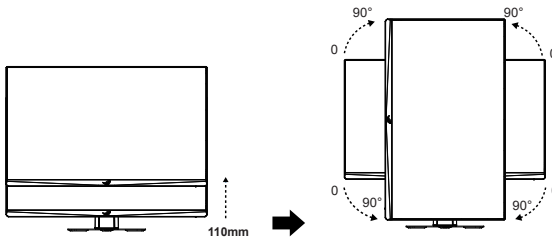
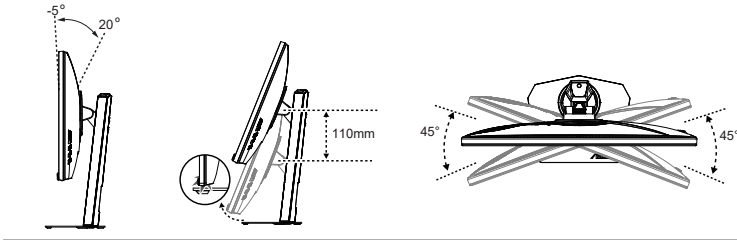

It is normal that the monitor slightly shakes while you adjust the viewing angle.

2.1 Monitor introduction

2.1.1 Front view

Use the control button on the back of the monitor to adjust the monitor settings.

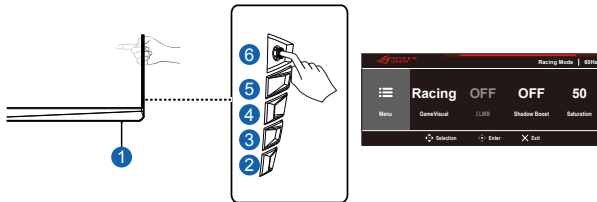

1. Power Indicator:

- The color definition of the power indicator is as the below table.

| Status | Description |
|--------|--------------|
| White | ON |
| Amber | Standby mode |
| OFF | OFF |





2.  Power Button:

- Press this button to turn the monitor on/off. Press this key to turn on the monitor when monitor is power off.

3.  Shortcut 1, default is GamePlus :

- GamePlus: The GamePlus Function provides a toolkit and creates a better gaming environment for users when playing different types of games. Particularly, Crosshair function is specially designed for new gamers or beginners interested in First Person Shooter (FPS) games.

To active GamePlus:

- Press **GamePlus** Button to enter the GamePlus main menu.
- Activate FPS Counter, Crosshair, Sniper, Timer, Stopwatch or Display Alignment function.
- Move the  button up/down to select and press  to confirm the function needed. Press  to go off, and exit.
- FPS Counter/Crosshair/Timer/Stopwatch is movable by pressing  5-way key.

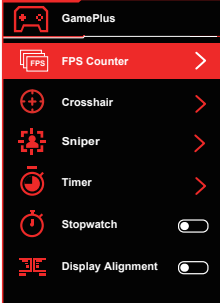
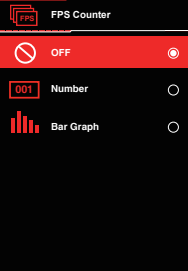
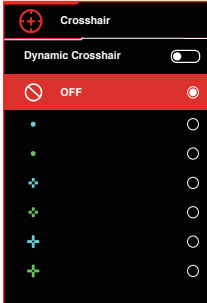
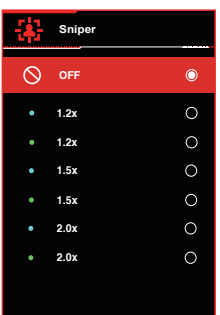
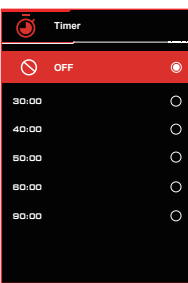
| GamePlus Shortcut menu | GamePlus-FPS | GamePlus-Crosshair |
|---|---|---|
|  |  |  |
| GamePlus-Sniper | GamePlus-Timer | |
|  |  | |

4.  Shortcut 2, default is GameVisual

The GameVisual function helps you select among different picture modes in a convenient way.

- **Scenery Mode:** This is the best choice for scenery photo or movie displaying with GameVisual™ Video intelligence Technology.
- **Racing Mode:** This is the best choice for racing game playing with GameVisual™ Video intelligence Technology and for document editing. In this mode is applied reduced input lag (by pass FRC).
- **Cinema Mode:** This is the best choice for generic movie watching and movie watching with GameVisual™ Video intelligence Technology.

- **RTS/RPG Mode:** This is the best choice for generic game playing and Real-Time Strategy (RTS)/ Role-Playing Game (RPG) playing with GameVisual™ Video intelligence Technology.
- **FPS Mode:** This is the best choice for dark scenery game playing, movie watching, and First Person Shooter game playing with GameVisual™ Video intelligence Technology.
- **sRGB Mode:** This is the best choice for viewing photos and graphics from PCs.
- **MOBA Mode:** This is the best choice for Multiplayer Online Battle Arena (MOBA) games playing with GameVisual™ Video intelligence Technology.
- **Night Vision :** This is the best choice for dark scenery playing with **GameVisual™** Video intelligence Technology.
- **User Mode:** More items are adjustable in the Color menu.



-
- In the sRGB Mode, the Contrast and Color functions are not user-configurable.
 - In the MOBA Mode, the Saturation, VividPixel and Six-axis Saturation functions are not user-configurable.
-

5.  Close Button:

- Exit the OSD menu.

6.   5-way) Button:

- Turn on the OSD menu. Enacts the selected OSD menu item.
- Increases/Decreases values or moves your selection up/down/left/right.

2.1.2 Back view

Rear of the LCD monitor

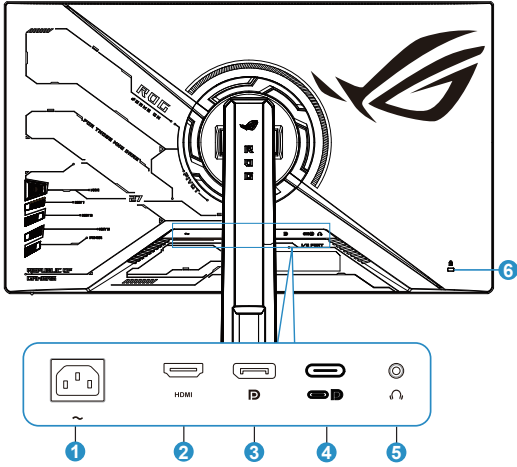

1. AC-IN Port
2. HDMI Port
3. DisplayPort
4. Type-C (5V/3A) Port (DP alt mode support)
5. Earphone Jack
6. Kensington Lock

2.1.3 Other Function(s)

- **Tripod socket atop**

1/4-inch tripod socket on the monitor stand allows you to mount a camera, audio equipment or additional display.

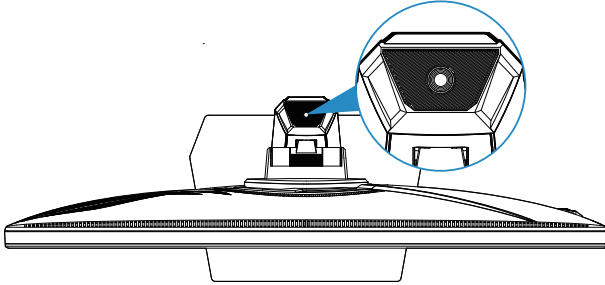

3.1 OSD (On-Screen Display) menu

3.1.1 How to reconfigure

The 5-way controller is located at the rear of the monitor. While sitting in front of the monitor, move the controller to the directions instructed by the on-screen icons for menu navigation and operations.

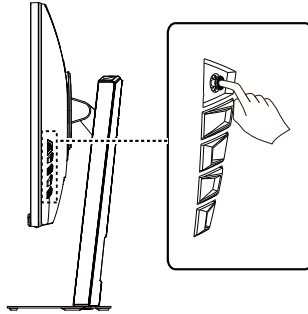

Press the ( 5-way) button to activate the OSD menu.

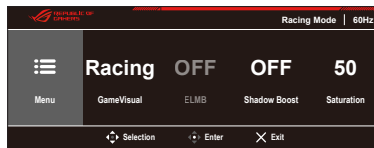

- When the Quick Menu is activated

| OSD (On Screen Display) icon | 5-way controller operation | Function |
|------------------------------|----------------------------|---|
| Quick Menu | Move left / right | Switches to the previous / next menu setting. |
| | Move up / down | Selects the previous / next menu item. |
| | | Selects the desired parameter |
| Press (center) | | Confirms the selection |

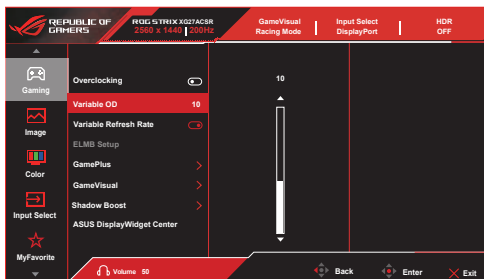

- When the Menu is activated

| OSD (On Screen Display) icon | 5-way controller operation | Function |
|------------------------------|----------------------------|--|
| Menu | Move up / down | Selects the previous / next menu item. |
| | | Selects the desired parameter |
| | Move left / right | Switches to the left / right menu. |
| | Press (center) | Confirms the selection |

Customizing the Quick Menu

The Quick Menu contains four customizable shortcuts that allow fast access to frequently used settings. You may change these shortcuts as desired.

1. Press the 5-way controller to bring up the Quick Menu.
2. Navigate to Menu > MyFavorite > Quick Menu.
3. Select Mode 1, Mode 2, Mode 3, or Mode 4 to set a function.

Available functions include:

- GameVisual
- ELMB
- Shadow Boost
- Saturation
- Brightness
- Variable Refresh Rate
- Contrast
- Input Select
- Gamma
- VividPixel
- Variable OD
- Color Temp.

-To keep the Quick Menu shorter, select None to hide that shortcut.

-Do not select the same function to multiple positions.

-A shortcut will appear grayed out if it is not supported under the current mode.

3.1.2 OSD Function Introduction

Set **Power Setting to Performance Mode** to enable function.

3.1.2.1. Gaming

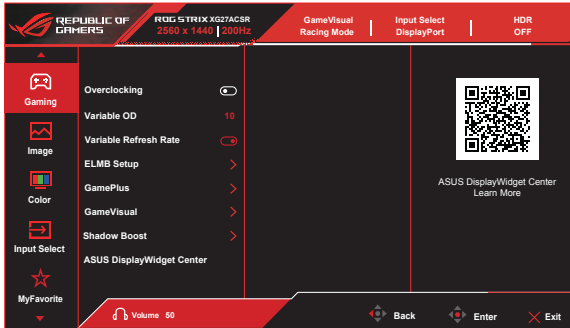

| Menu Option | | Description | Remark |
|-----------------------|--------|---|--|
| Overclocking | On/Off | Enabling overclocking allows the monitor to reach its maximum supported refresh rate (220Hz), delivering smoother and more responsive visuals. | <ol style="list-style-type: none"> Overclocking may cause screen flickering. To reduce such effects, disconnect the cable and use the monitor OSD to try again with a safer Max Refresh Rate. Overclocking ability is dependent on the graphics card. |
| Variable OD | 0-20 | Improves screen response time with 20 adjustable Over Drive levels, making fast-moving scenes look sharper and smoother. | |
| Variable Refresh Rate | On/Off | Works with Adaptive-Sync, G-Sync Compatible, and FreeSync graphics sources to dynamically match the display's refresh rate to content frame rates. This reduces stutter and input lag while saving power. | <ol style="list-style-type: none"> Variable Refresh Rate can only be activated within 48Hz~200Hz when Overclocking is OFF, 48Hz~220Hz when Overclocking is ON. For supported GPUs, minimum PC system and driver requirements, please contact the GPU manufacturers. When Variable Refresh Rate is enabled, the following functions will be unavailable:ELMB |

| Menu Option | | Description | Remark |
|-------------|------------------|--|---|
| ELMB Setup | ELMB | <p>The ELMB Setup menu allows users to configure motion blur reduction features for fast-moving content. It includes ELMB and ELMB Sync, depending on the input signal and refresh rate conditions.</p> <p><u>ELMB</u></p> <p>ELMB eliminates screen tearing, reduces ghosting, and minimizes motion blur during gameplay.</p> | <p>1.To activate ELMB, please turn off VRR first.</p> <p>2.Requires refresh rate higher than 85Hz.</p> <p>3.When ELMB is enabled, the following functions will be unavailable:Variable Refresh Rate,ELMB Sync,Brightness, Aspect Control,Dynamic Dimming, ASCR,Blue Light Filter,Variable OD,HDR Setting,Sniper</p> |
| ELMB Setup | ELMB SYNC | <p><u>ELMB Sync</u></p> <p>ELMB SYNC allows you to enable motion blur reduction while Variable Refresh Rate (VRR) is ON.</p> | <p>1.When ELMB sync is enabled, the following functions will be unavailable:ELMB,Brightness, Aspect Control,Dynamic Dimming ASCR,Blue Light Filter,HDR Setting,Variable OD</p> |
| ELMB Setup | Clarity Level | <p>It helps eliminate screen tearing, reduce ghosting, and minimize motion blur during fast-paced gameplay.</p> <p><u>Clarity Level</u></p> <p>Adjusts the sharpness level of the ELMB effect.</p> | <p>1.When Clarity Level or Clarity Position is enabled, the following functions will be unavailable: Variable Refresh Rate,ELMB Sync,Brightness,Aspect Control, Dynamic Dimming,ASCR, Blue Light Filter,Variable OD, HDR Setting</p> |
| ELMB Setup | Clarity Position | <p>There are 5 clarity levels available, allowing you to fine-tune motion clarity based on your preference.</p> <p><u>Clarity Position</u></p> <p>Adjusts where the blur-reduction effect appears on screen.</p> <p>Choose from 3 levels — Top, Middle, or Bottom — to match different types of content.</p> | |

| Menu Option | | Description | Remark |
|-------------|-------------------|---|--------|
| GamePlus | FPS Counter | <p>The GamePlus function provides a set of built-in gaming tools to enhance your in-game experience.</p> <p>It includes the following features:</p> <p><u>FPS Counter</u></p> <p>Displays real-time frames per second (FPS) to indicate how smoothly the game is running.</p> | |
| GamePlus | Crosshair | <p>You can choose to show the FPS as a number or a bar graph on screen.</p> <p><u>Crosshair</u></p> <p>Provides 6 built-in crosshair styles, so you can choose the one that best fits your game.</p> | |
| GamePlus | Sniper | <p>Also includes a Dynamic Crosshair option that adjusts the crosshair automatically based on gameplay.</p> <p><u>Sniper</u></p> <p>Sniper mode is designed for first-person shooter games (only available when HDR is OFF).</p> | |
| GamePlus | Timer | <p>You can choose from three magnification levels — 1.2x, 1.5x, and 2.0x — with different alignment styles.</p> <p><u>Timer</u></p> <p>Displays a countdown timer on the upper-left corner of the screen to help you track gameplay or rest time.</p> | |
| GamePlus | Stopwatch | <p>You can choose from the following preset durations:30:00, 40:00, 50:00, 60:00, or 90:00 minutes.</p> <p><u>Stopwatch</u></p> <p>Displays a stopwatch on the upper-left corner of the screen to help you track elapsed time during gameplay or activities.</p> | |
| GamePlus | Display Alignment | <p>The stopwatch starts from 00:00 and counts upward until manually stopped.</p> <p><u>Display Alignment</u></p> <p>Displays alignment lines on all four sides of the screen to help you align multiple monitors more precisely and easily.</p> | |

| Menu Option | | Description | Remark |
|---------------------------|--|---|--------|
| GameVisual | Scenery Mode | GameVisual provides a set of preset display modes optimized for different usage scenarios, using ASUS GameVisual™ Video Intelligence Technology. Easily switch between modes to match your content. | |
| GameVisual | Racing Mode | Scenery Mode Optimized for displaying landscapes and outdoor photos. | |
| GameVisual | Cinema Mode | Racing Mode Best suited for fast-paced racing games. | |
| GameVisual | RTS/RPG Mode | Cinema Mode Ideal for watching movies and cinematic content. | |
| GameVisual | FPS Mode | RTS/RPG Mode Designed for Real-Time Strategy and Role-Playing games. | |
| GameVisual | sRGB Mode | FPS Mode Tailored for First-Person Shooter games to enhance visibility in dark scenes. | |
| GameVisual | MOBA Mode | sRGB Mode Perfect for viewing photos and graphics with accurate color reproduction. | |
| GameVisual | Night Vision | MOBA Mode Best choice for Multiplayer Online Battle Arena games. | |
| GameVisual | User Mode | Night Vision Enhances visibility in dark environments or low-light scenes. | |
| GameVisual | User Mode | User Mode Allows manual adjustment of more image settings like brightness, contrast, and color. | |
| Shadow Boost | Dynamic Shadow Boost/Level 3/Level 2/Level 1/Off | Enhances visibility in dark areas by adjusting the monitor's gamma curve, making dark scenes and objects easier to see without overexposing brighter areas. Offers three levels (Level 1 / 2 / 3) of adjustment to suit different preferences. Includes a Dynamic Shadow Boost option that automatically optimizes dark scenes based on the content. | |
| ASUS DisplayWidget Center | QRcode | Refer to Chapter 3.2 | |

3.1.2.2. Image

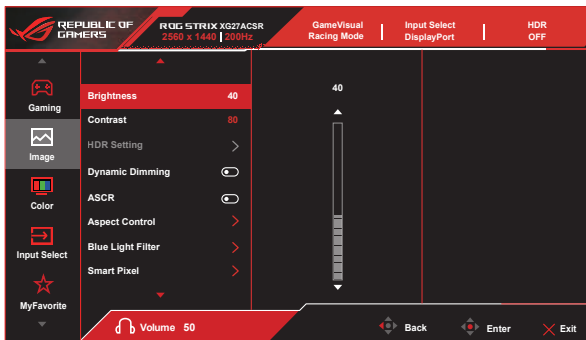

| Menu Option | | Description | Remark |
|-------------|-----------------------|--|---|
| Brightness | Adjustable from 0~100 | Adjust screen brightness. When HDR is enabled, only adjustment via Adjustable HDR is supported. | ELMB function not supported. |
| Contrast | Adjustable from 0~100 | Adjust contrast to enhance image detail and depth. | Not adjustable in HDR mode. |
| HDR Setting | Gaming HDR | <p>Function Description: Delivers richer details and more realistic colors, especially noticeable in scenes with strong contrast between light and dark areas.</p> <p>Gaming HDR: A mode designed for gamers.</p> <p>Cinema HDR: Ideal for movies and cinematic content.</p> <p>Console HDR: Tailored for gaming consoles.</p> | <p>1. In HDR mode, brightness is adjusted automatically and cannot be set manually.</p> <p>2. When HDR is enabled, the following functions are unavailable: ELMB, Sniper, GameVisual, Shadow Boost, Brightness, Contrast, Aspect Control (only mutually exclusive if Dynamic Dimming is supported), Blue Light Filter, ASCR, Color Temp., Display Color Space, Gamma, Saturation, Six Saturation, Power Saving.</p> |
| HDR Setting | Cinema HDR | | |
| HDR Setting | Console HDR | | |
| HDR Setting | Adjustable HDR | <p>You can adjust the intensity of the HDR effect.</p> <p>Adjustable HDR is enabled, the following settings can be customized: Brightness, Contrast, Color Temperature, Saturation, and Six-axis Saturation.</p> | <p>When this feature is enabled, the following functions will be unavailable: ELMB, Sniper, GameVisual, Shadow Boost, Gamma, Blue Light Filter, Power Saving, ASCR, Display Color Space, Aspect Control (only mutually exclusive if Dynamic Dimming is supported).</p> |

| Menu Option | | Description | Remark |
|-----------------|-----------------------|--|--|
| Dynamic Dimming | On/Off | Enhances screen visual quality and energy efficiency. When enabled, this feature automatically adjusts the backlight brightness to deliver a more vivid and realistic image while also saving power. | Only supports local dimming. Default is OFF in SDR mode; ON in HDR mode. |
| ASCR | On/Off | Dynamically adjusts contrast, ideal for videos or high-dynamic scenes, enhancing the depth and layering of the image. | When this feature is enabled, ELMB, ELMB SYNC, and ELMB settings cannot be used. |
| Aspect Control | 16:9 Full | Fills the screen by stretching the image without preserving the aspect ratio. The image becomes larger but may distort, affecting the viewing experience. | <p>1. The 16:9 aspect ratio achieves better results only when the full-screen resolution simulates a 24.5-inch display.</p> <p>2. FPS game size; you can also select point-to-point scaling in Windows display settings.</p> <p>3. When this feature is enabled, the following functions will be disabled: VRR, ELMB, ELMB SYNC.</p> |
| Aspect Control | 16:9 24.5" Simulation | Displays the image at a 24.5-inch size, maintaining the aspect ratio without distortion, but the image appears smaller. | |
| Aspect Control | 16:9 Pixel by Pixel | 16:9 native mode maps pixels directly, keeping clarity and aspect ratio. Low resolution images may show black borders. | |
| Aspect Control | Square Full | Stretches the image to fill the entire screen without preserving the aspect ratio. The image becomes larger but may be distorted, affecting the viewing experience. | |
| Aspect Control | Square Equivalent | Scales the image up while maintaining the original aspect ratio to avoid distortion, but may result in black borders. | |
| Aspect Control | Square Pixel by Pixel | Displays the image at its original resolution without scaling or stretching. | |

| Menu Option | | Description | Remark |
|-------------------|---|--|--|
| Blue Light Filter | Level4/ Level3/ Level2/ Level1/OFF | <p>1. Levels 1 to 4: The higher the level, the stronger the blue light filtering effect, resulting in less blue light scattering.</p> <p>2. Level and brightness adjustment: Users can adjust brightness between levels 1 and 3.</p> <p>3. Level 4 is the default optimal setting, compliant with TÜV low blue light certification standards, but brightness cannot be adjusted.</p> | <p>1. When this feature is enabled, the following functions will be disabled: ELMB, ELMB SYNC.</p> <p>2. When this feature is enabled, the system will automatically apply the default settings of Competition Mode.</p> |
| Smart Pixel | Level3/ Level2/ Level1/OFF | Smart Pixel enhances overall image details in real time for clearer and more vivid visuals. | |
| VividPixel | Adjustable from 0-100 | Enhances image edges and details to improve image clarity. | |

3.1.2.3. Color

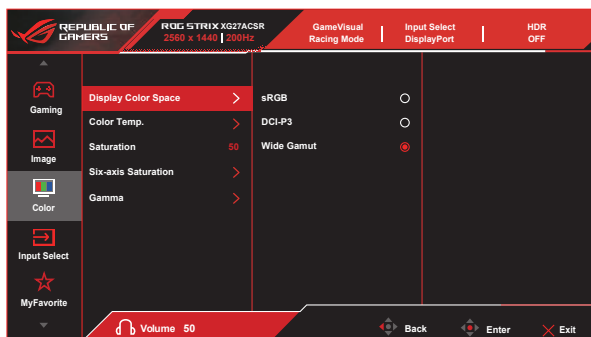

| Menu Option | Description | | Remark |
|---------------------|-----------------------|----------------------------|--|
| Display Color Space | sRGB | - | Selects the color space for the monitor color output. |
| Display Color Space | DCI-P3 | - | |
| Display Color Space | Wide Gamut | - | |
| Color Temp. | 4000K | - | Contains 8 modes including 4000K, 5000K, 6500K, 7500K , 8200K, 9300K, 10000K and User. |
| Color Temp. | 5000K | - | |
| Color Temp. | 6500K | - | |
| Color Temp. | 7500K | - | |
| Color Temp. | 8200K | - | |
| Color Temp. | 9300K | - | |
| Color Temp. | 10000K | - | |
| Color Temp. | User | R Adjustable from 0~100 | |
| Color Temp. | User | G Adjustable from 0~100 | |
| Color Temp. | User | B Adjustable from 0~100 | |
| Saturation | Adjustable from 0~100 | - | |

| Menu Option | | Description | Remark |
|---------------------|-----|----------------------------|--|
| Six-axis Saturation | R | R Adjustable from 0-100 | Adjusts the saturation for R, G, B, C, M, Y. |
| Six-axis Saturation | G | G Adjustable from 0-100 | |
| Six-axis Saturation | B | B Adjustable from 0-100 | |
| Six-axis Saturation | C | C Adjustable from 0-100 | |
| Six-axis Saturation | M | M Adjustable from 0-100 | |
| Six-axis Saturation | Y | Y Adjustable from 0-100 | |
| Gamma | 1.8 | | Gamma is a curve used to adjust image brightness and contrast, affecting how the brightness of an image signal (such as a photo file or video signal) is mapped to what is shown on the screen. Allows you to set the color mode to 1.8, 2.0, 2.2, 2.4 or 2.6. |
| Gamma | 2.0 | | |
| Gamma | 2.2 | | |
| Gamma | 2.4 | | |
| Gamma | 2.6 | | |

3.1.2.4. Input Select



| Menu Option | | Description | Remark |
|----------------------|------------------------------------|--|--------|
| Auto Input Detection | On / Off | Once turned on, it automatically detects the signal and switches the input source. | |
| USB-C | Choose the input source as needed. | Select USB-C as the video input source. | |
| DisplayPort | | Select DisplayPort as the video input source. | |
| HDMI | | Select HDMI as the video input source. | |

3.1.2.5. MyFavorite

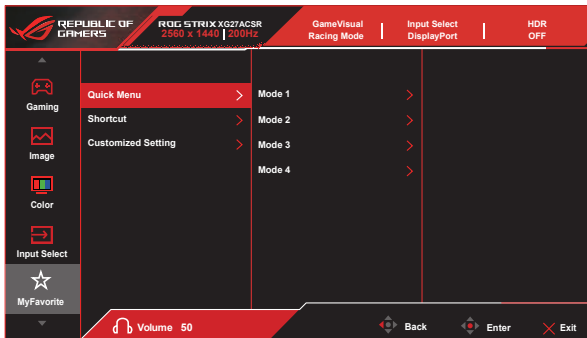

| Menu Option | | Description | Remark |
|--------------------|--|--|--------|
| Quick Menu | Mode1 or Mode2 or Mode3 or Mode4 | The Quick Menu lets you assign your favorite monitor settings to four modes (Mode 1–4) for faster access during use. | |
| Shortcut | Shortcut 1 or Shortcut 2 | Configure the functions of the monitor's shortcut keys. | |
| Customized Setting | Customized Setting 1 or Customized Setting 2 | Load or save all monitor settings to quickly switch between different usage scenarios. | |

3.1.2.6. System Setup

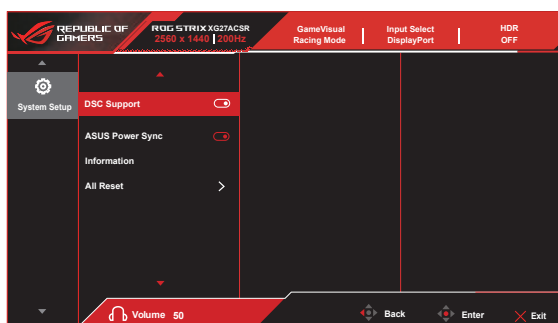
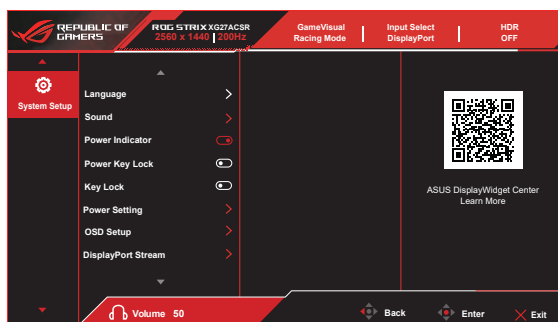

| Menu Option | | Description | Remark |
|-----------------|-----------------------|---|--------|
| Language | Language Selection | Supports 23 languages: English, French, German, Italian, Spanish, Dutch, Portuguese, Russian, Czech, Croatian, Polish, Romanian, Hungarian, Turkish, Simplified Chinese, Traditional Chinese, Japanese, Korean, Thai, Indonesian, Persian, Ukrainian, and Vietnamese. | |
| Sound | Volume (Earphone Out) | Adjustable from 0-100 | |
| | Mute | Switch the monitor sound on or off. | |
| Power Indicator | On/Off | Switch the power LED indicator on or off. | |
| Power Key Lock | On/Off | Turn the power button on or off. | |
| Key Lock | On/Off | All function keys are disabled. To unlock, press and hold the down key on the five-way button for five seconds. | |

| Menu Option | | Description | Remark |
|--------------------|------------------------------------|--|--------|
| Power Setting | Performance Mode | Offers better performance but consumes more power. | |
| | Power Saving Mode | Limits brightness and features to save energy. HDR must be turned off before enabling this; a reminder will appear when adjusting brightness. | |
| OSD Setup | OSD Position | Adjust the horizontal and vertical position of the OSD menu. | |
| | OSD Timeout | Adjust the menu display duration between 10 and 120 seconds. | |
| | Transparency | Adjust the OSD background transparency. | |
| | DDC/CI | Turn on or off the communication between the monitor and computer (auto-enabled with variable refresh rate). | |
| DisplayPort Stream | DisplayPort 1.2 or DisplayPort 1.4 | Select DisplayPort 1.2 or DisplayPort 1.4 based on the graphics card. | |
| DSC Support | On/Off | It is specifically designed for high-resolution video transmission and high refresh rates. It compresses image data without noticeably degrading quality, allowing displays and devices to transmit large amounts of video data using lower bandwidth. | |
| ASUS Power Sync | On/Off | Automatically powers the monitor and connected devices on or off (compatible with Apple TV, PlayStation, Xbox, Switch, and more). | |
| Information | - | Displays the current resolution, refresh rate, and other information of the monitor. | |
| All Reset | Yes or No | Reset all settings to their factory default values. | |



To ensure proper display, the color depth, resolution, or color format may be automatically adjusted when the DSC (Display Stream Compression) function is turned off.

3.2 Display Widget Center

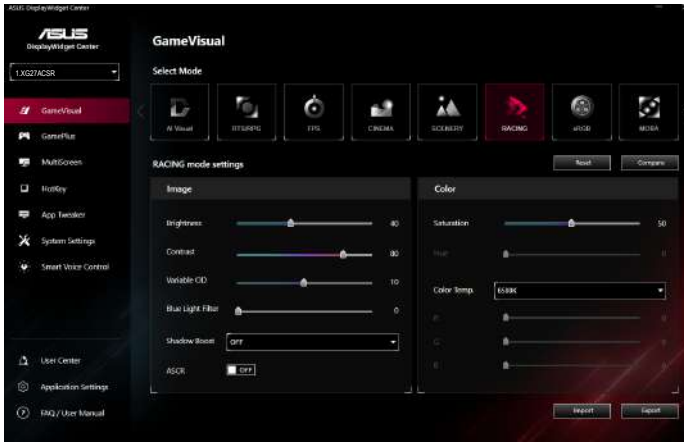

ASUS DisplayWidget Center is a Windows-based utility designed for ASUS monitors. It allows users to adjust monitor settings directly from their desktop using a mouse, eliminating the need for on-screen display (OSD) buttons. It streamlines configuration of color, brightness, contrast, and other advanced features.

System Requirements

*Operating System: Windows 10 (64-bit) or Windows 11 (64-bit)

*Supported Models: Please check the driver section on the ASUS Support Site (<https://www.asus.com/support/>) by entering your monitor model.

How to Download and Install

1. Go to the ASUS DisplayWidget Center download page.
2. Enter your monitor model in the search bar (e.g., XG27ACSR).
3. Select Driver & Utility Choose your OS version.
4. Download and unzip the DisplayWidget Center installer.
5. Run the setup file and follow the installation steps.
6. Once installed, the shortcut icon will appear on your desktop.

Key Features

1. GameVisual Modes: Change between Scenery, Racing, Cinema, FPS, RPG, and other color presets.

2. GamePlus Tools: Activate crosshairs, FPS counter, sniper, timer, and display alignment tools.
3. Color Adjustment: Fine-tune brightness, contrast, saturation, and gamma directly from your PC.
4. Multi-Screen Tools: Organize and divide your desktop workspace with layout presets.
5. Hotkey Customization: Assign shortcuts for quick access to settings.
6. Device & System Info: View real-time system and monitor information.

Tips for Users

1. Always check for the latest version through the official ASUS website.
2. If you change monitor models, reinstalling the tool may be necessary.
3. Some features may vary depending on your monitor model and panel type.

3.3 Specifications summary

| Model | XG27ACSR | XG27ACSR-W |
|------------------------------------|---|------------|
| Chassis Colors | Black | White |
| Panel Type | LCD | |
| Backlight Type | E-LED | |
| Panel Size | 27" W (68.5 cm) | |
| Recommend Resolution | 2560 x 1440 | |
| Refresh Rate | 220Hz (overclocking) | |
| Aspect Ratio | 16:9 | |
| Brightness (Typ.) | 350nits (Typ.)/ 500nits (HDR peak) | |
| Color Space (sRGB) | sRGB 133% (Typ.) | |
| Color Space (DCIP3) | DCI-P3 97% (Typ.) | |
| Intrinsic Contrast Ratio (Typ.) | 1300:1 | |
| Viewing Angle (CR>10) | 178°(V) /178°(H) | |
| Display Colors | 1.07B (RGB 8 bit + Hi-FRC) | |
| Response Time | 0.3ms (min, Gray to Gray) | |
| WHQL | Windows 10/11 | |
| Digital signal Frequency | 30-350KHz (H) 48-220Hz (V) | |
| Power Consumption | 19 W** | |
| Power saving mode | < 0.5W | |
| Power off mode | < 0.3W | |
| Voltage | 100~240V, 50/60Hz, 1.5A | |
| Temperature (operating) | 0 ~ 40° | |
| Tilt | -5° ~ +20° | |
| Swivel | -45° ~ +45° | |
| Pivot | -90° ~ +90° | |
| Height Adjustment | 110 mm | |
| I/O Port | HDMI v2.1 x 1 , DisplayPort v1.4 x 1 USB Type-C x 1 | |
| Speaker | NA | |
| Phys. Dimension with stand (WxHxD) | 614.84 x 503.41 x 187.87 mm (highest) 614.84 x 393.41 x 187.87 mm (lowest) | |

| | |
|---------------------------------------|----------------------------|
| Phys. Dimension without stand (WxHxD) | 614.84 x 367.12 x 63.02 mm |
| Box Dimension (WxHxD) | 840 x 186 x 515 mm |
| Net Weight (Esti.) | 5.94 kg |
| Net Weight without stand | 3.83 kg |
| Gross Weight (Esti.) | 8.25 kg |

***Specifications are subject to change without notice.**

****Measuring a screen brightness of 200 nits without audio/ USB/ Card reader connection.**

3.4 Outline dimension

Unit: mm

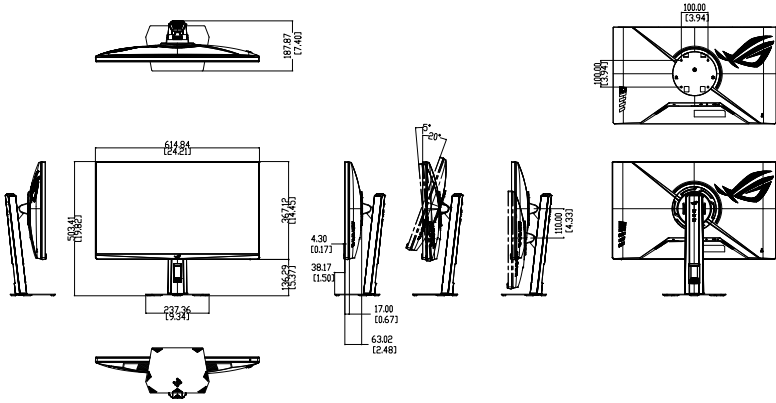

3.5 Troubleshooting (FAQ)

| Problem | Possible Solution |
|--|--|
| Power LED is not ON | <ul style="list-style-type: none">• Press the ⏻ button to check if the monitor is in the ON mode.• Check if the power cord is properly connected to the monitor and the power outlet.• Check Power Indicator function in main menu OSD. Select "ON" to turn on power LED. |
| The power LED lights amber and there is no screen image | <ul style="list-style-type: none">• Check if the monitor and the computer are in the ON mode.• Make sure the signal cable is properly connected the monitor and the computer.• Inspect the signal cable and make sure none of the pins are bent.• Connect the computer with another available monitor to check if the computer is properly working. |
| Screen image is too light or dark | <ul style="list-style-type: none">• Adjust the Contrast and Brightness settings via OSD. |
| Screen image bounces or a wave pattern is present in the image | <ul style="list-style-type: none">• Make sure the signal cable is properly connected to the monitor and the computer.• Move electrical devices that may cause electrical interference. |
| Screen image has color defects (white does not look white) | <ul style="list-style-type: none">• Inspect the signal cable and make sure that none of the pins are bent.• Perform Reset via OSD.• Adjust the R/G/B color settings or select the Color Temperature via OSD. |
| No sound or sound is low | <ul style="list-style-type: none">• Adjust the volume settings of both your monitor and computer.• Make sure the computer sound card driver is properly installed and activated.• Check the audio source. |

3.6 Supported Timing List

Support Timing

| Timing | Resolution | HDMI | DP/Type-C |
|--------------|-------------------|------|-----------|
| PC Timing | 640 x 480 60Hz | V | V |
| PC Timing | 640 x 480 75Hz | V | V |
| PC Timing | 800 x 600 60Hz | V | V |
| PC Timing | 800 x 600 75Hz | V | V |
| PC Timing | 1024 x 768 60Hz | V | V |
| PC Timing | 1024 x 768 75Hz | V | V |
| PC Timing | 1280 x 720 60Hz | V | V |
| PC Timing | 1280 x 960 60Hz | V | V |
| PC Timing | 1280 x 1024 60Hz | V | V |
| PC Timing | 1600 x 1200 60Hz | V | V |
| PC Timing | 1920 x 1080 60Hz | V | V |
| Video Timing | 640 x 480 60Hz | V | V |
| Video Timing | 720 x 480 60Hz | V | V |
| Video Timing | 720 x 576 50Hz | V | V |
| Video Timing | 1280 x 720 50Hz | V | V |
| Video Timing | 1280 x 720 60Hz | V | V |
| Video Timing | 1920 x 1080 24Hz | V | V |
| Video Timing | 1920 x 1080 25Hz | V | V |
| Video Timing | 1920 x 1080 30Hz | V | V |
| Video Timing | 1920 x 1080 50Hz | V | V |
| Video Timing | 1920 x 1080 60Hz | V | V |
| Video Timing | 1920 x 1080 100Hz | V | V |
| Video Timing | 1920 x 1080 120Hz | V | V |
| Video Timing | 3840 x 2160 24Hz | V | |
| Video Timing | 3840 x 2160 25Hz | V | |
| Video Timing | 3840 x 2160 30Hz | V | |
| Video Timing | 3840 x 2160 50Hz | V | |
| Video Timing | 3840 x 2160 60Hz | V | |
| Video Timing | 3840 x 2160 100Hz | V | |
| Video Timing | 3840 x 2160 120Hz | V | |

24.5" Simulation Timing

| Timing | Resolution | HDMI | DP/Type-C |
|---------------|-------------------|------|-----------|
| Detail Timing | 2560 x 1440 60Hz | V | V |
| Detail Timing | 2560 x 1440 120Hz | V | V |
| Detail Timing | 2332 x 1308 60Hz | V | V |
| Detail Timing | 2332 x 1308 120Hz | V | V |
| Detail Timing | 2332 x 1308 200Hz | V | V |
| Detail Timing | 2332 x 1308 220Hz | V | V |

Square Timing

| Timing | Resolution | HDMI | DP/Type-C |
|---------------|-------------------|------|-----------|
| Detail Timing | 1024 x 768 200Hz | V | V |
| Detail Timing | 1024 x 768 220Hz | V | V |
| Detail Timing | 1152 x 864 200Hz | | V |
| Detail Timing | 1152 x 864 220Hz | | V |
| Detail Timing | 1280 x 960 200Hz | V | V |
| Detail Timing | 1280 x 960 220Hz | V | V |
| Detail Timing | 1440 x 1080 200Hz | V | V |
| Detail Timing | 1440 x 1080 220Hz | V | V |
| Detail Timing | 1720 x 1080 200Hz | V | V |
| Detail Timing | 1720 x 1080 220Hz | V | V |
| Detail Timing | 1920 x 1440 200Hz | V | V |
| Detail Timing | 1920 x 1440 220Hz | V | V |
| Detail Timing | 2560 x 1440 60Hz | V | V |
| Detail Timing | 2560 x 1440 120Hz | V | V |

16:9 Timing

| Timing | Resolution | HDMI | DP/Type-C |
|---------------|-------------------|------|-----------|
| Detail Timing | 1920 x 1080 200Hz | V | V |
| Detail Timing | 2560 x 1440 60Hz | V | V |
| Detail Timing | 2560 x 1440 120Hz | V | V |
| Detail Timing | 2560 x 1440 144Hz | V | V |
| Detail Timing | 2560 x 1440 165Hz | V | V |
| Detail Timing | 2560 x 1440 200Hz | V | V |
| Detail Timing | 2560 x 1440 220Hz | V | V |



REPUBLIC OF
GAMERS